

LEASE PLAN EASTVIEW BUSINESS CENTER

An **AshleyCapital** Development

2195 EASTVIEW PARKWAY NE
CONYERS, GA 30013
SITE ACREAGE: 4.19 ACRES

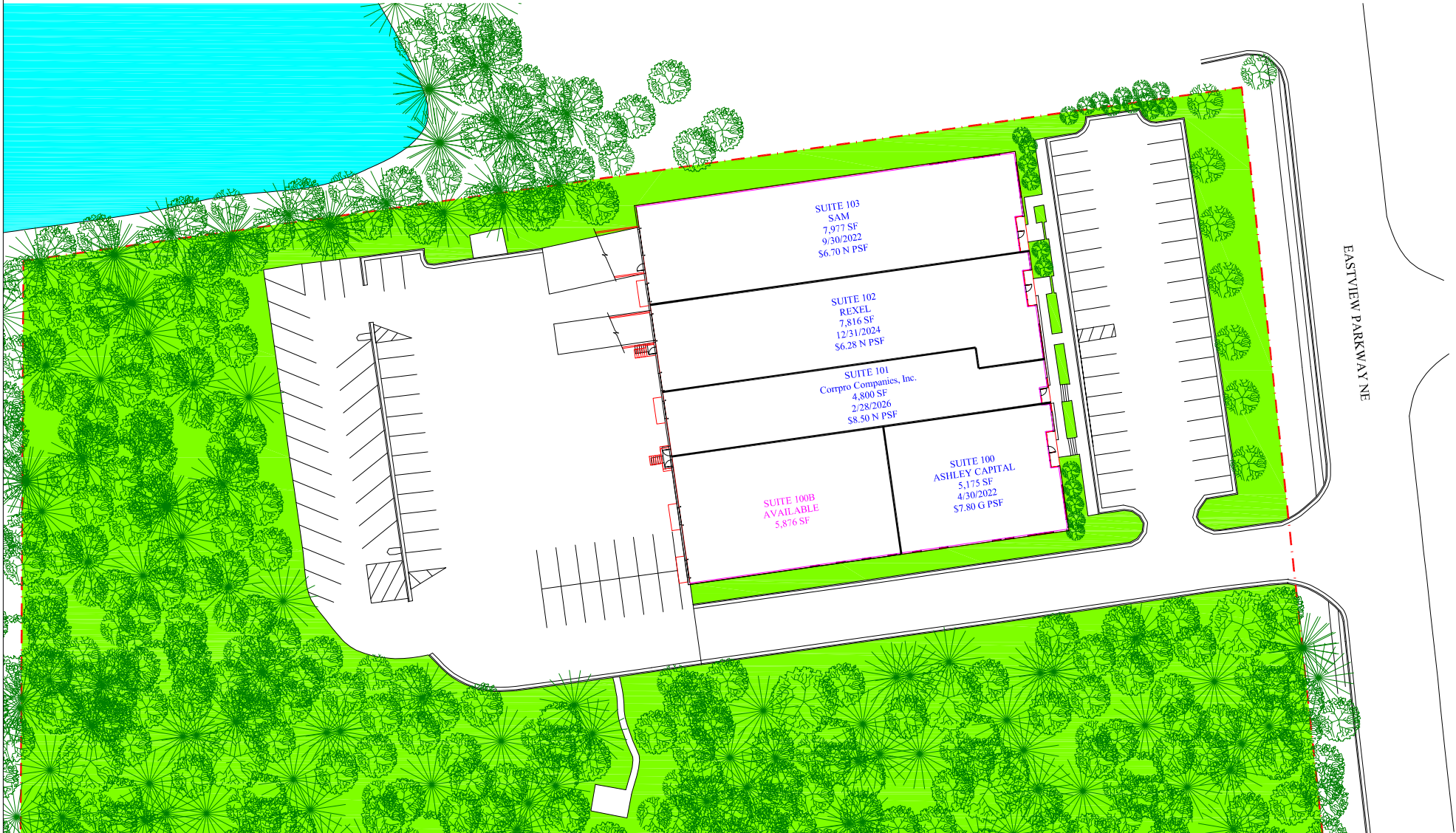

Notes:
REXEL: Option to extend for 5 years at market rates w/ notice by 7/1/24.
SAM: Two options to extend for 1 or 5 years at market rate w/ notice by 6/30/22.
CORPRO: Two options to extend for 3 years @ \$9.86 w/ 2% annual bumps w/ notice by 12/1/25 and 12/1/27. Option to terminate after 1/31/24 w/ 90 day written notice and business unit closure.

Magenta - Available
Red - Leases to expire or notices required within 12 months
Blue - Leases to expire in more than 12 months

