



Excellent Access to I-20

Great Labor Pool

Close to Retail Amenities
(Restaurants, Shopping, and
Hotels)

Pro-Business Government

Home to Many Manufacturing
and Distribution Companies:
SKC, General Mills, Bridgestone,
Pactiv, Nisshinbo, Old Castle
Glass, Valspar and C.R. Bard

Hazelbrand Rd NE

100±
ACRES

67±
ACRES

CSX

Hazelbrand Road, NE | Covington, Georgia 30014

Covington Logistics Park will be a 167 Acre master-planned park located 27 miles east of I-285 via I-20 in Covington, GA.

Covington Logistics Park is 1/2 mile from I-20 via Exit 93 (Hwy 142) providing excellent access for large distribution users.

Additionally, the Northern 67 acres are bordered by the CSX main rail line which provides the availability of rail service for manufacturers and distributors.

FOR MORE
INFORMATION
PLEASE CONTACT

BOBBY MAYSON
770.729.2817
BMAYSON@LAVISTA.COM

WWW.LAVISTA.COM

100 ACRE SITE

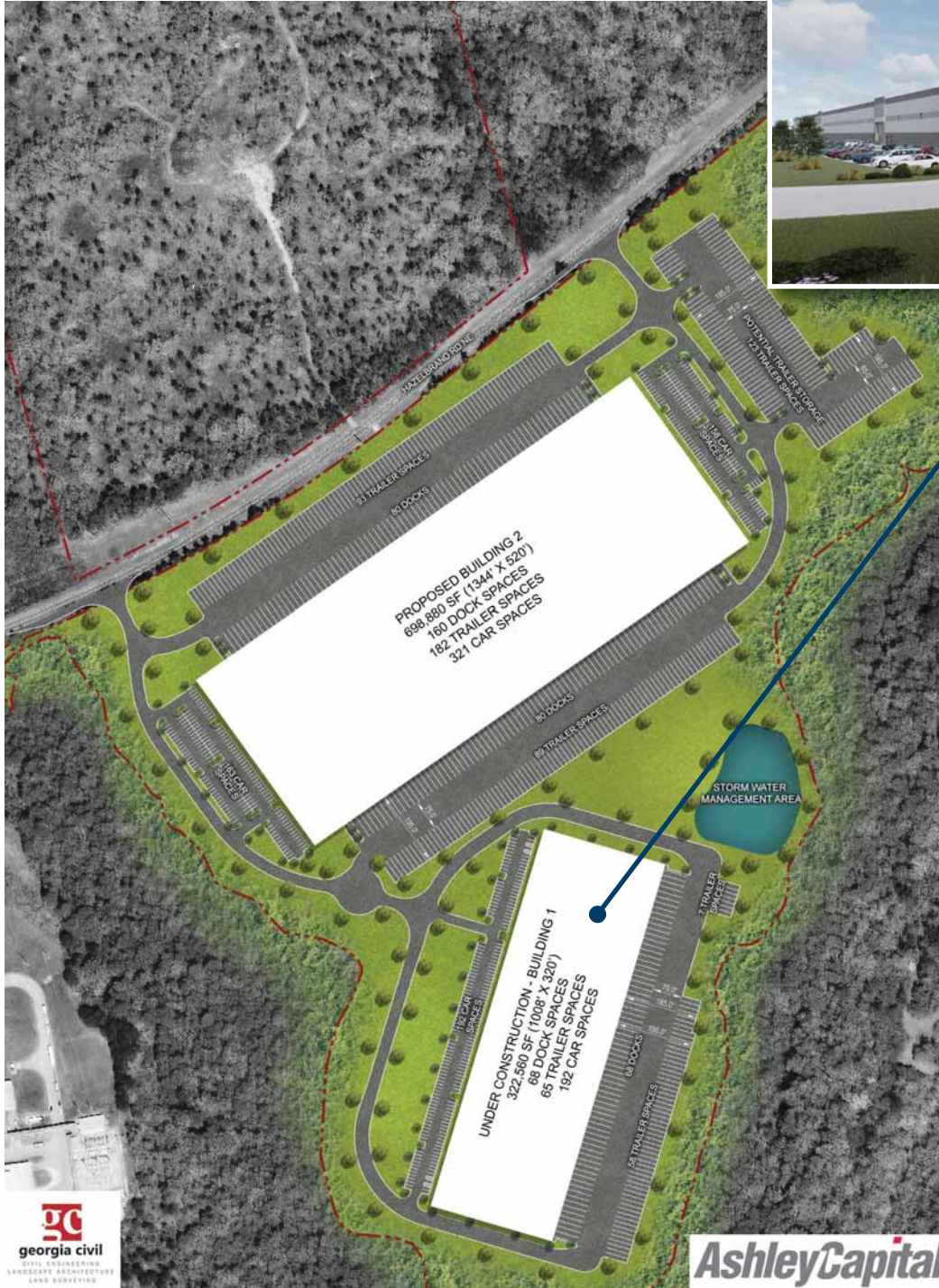

BUILDING 1
322,560 SF

Building 1

(Under Construction)

322,560 SF
1008' x 320'
68 Dock Spaces
65 Trailer Spaces
192 Car Spaces

Building 2

(Proposed)

698,880 SF
1344' x 520'
160 Dock Spaces
182 Trailer Spaces
321 Car Spaces



FOR MORE
INFORMATION
PLEASE CONTACT

BOBBY MAYSON
770.729.2817
BMAYSON@LAVISTA.COM

WWW.LAVISTA.COM

67 ACRE SITE

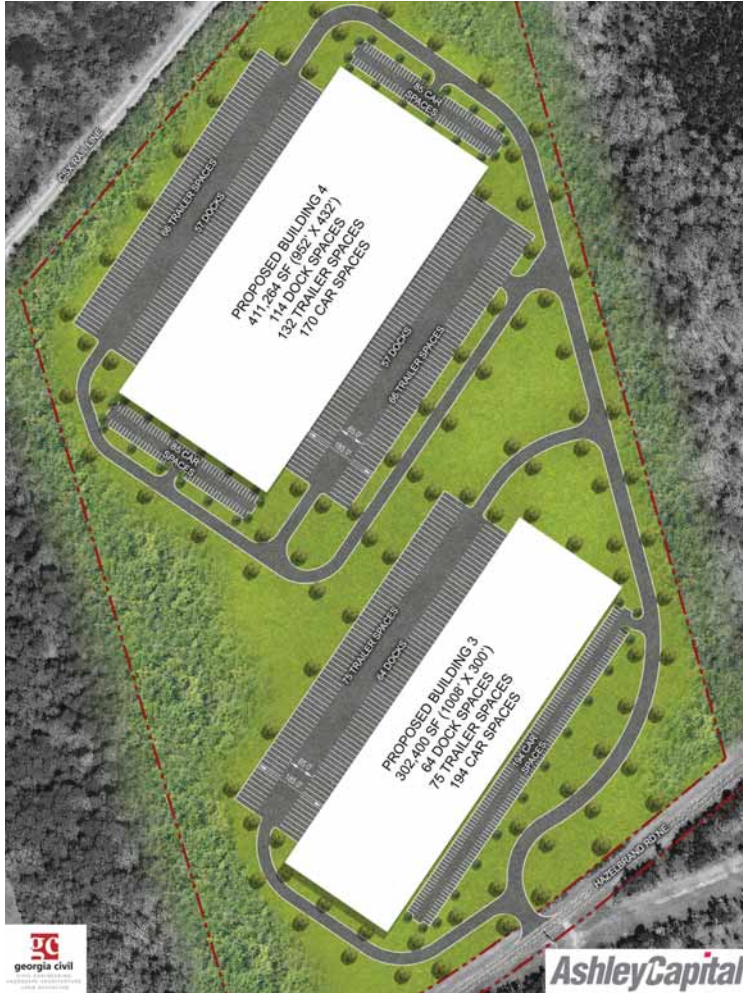

OPTION 'A'

Building 3
(Proposed)

302,400 SF
1008' x 300'
64 Dock Spaces
75 Trailer Spaces
194 Car Spaces

Building 4
(Proposed)

411,264 SF
952' x 432'
114 Dock Spaces
132 Trailer Spaces
170 Car Spaces



OPTION 'B'

Building 3
(Proposed)

659,680 SF
1064' X 620'
67 Dock Spaces w/ Rail
134 Dock Spaces w/o Rail
156 Trailer Spaces
400 Car Spaces

